 <p>INTERACTION DESIGN INSTITUTE IVREA</p>	<p>Venice Biennale Phase II Appendix: Mobile Phone</p>
---	--



Requirements

Installing a Java Application

Installation files may be transferred to your phone from a computer, downloaded during browsing, or sent to you in a multimedia message, as an e-mail attachment, via Bluetooth, or via infrared.

[Nokia 3650 User's guide]

requires a PC

requires a PC

requires a PC

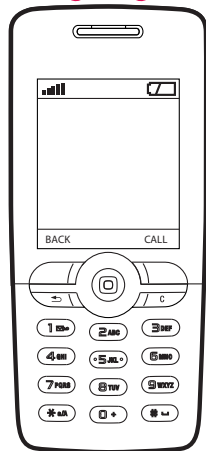

Infa-red

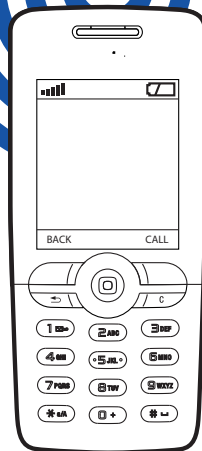

Bluetooth

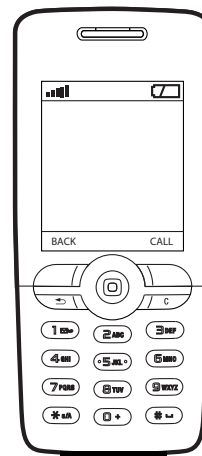

cable connection

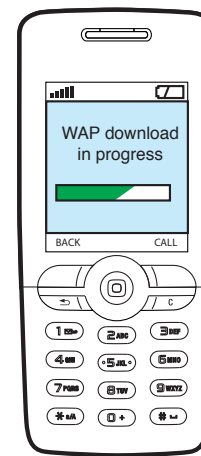

download

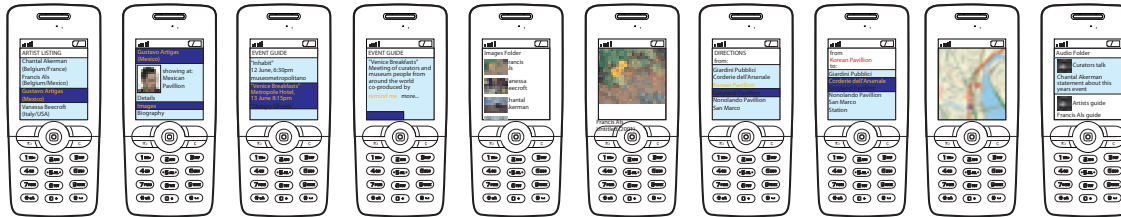

Mobile Navigation System

A dedicated device

In this document we are primarily targeting journalists for the initial few days of the Biennale with an application which provides map / schedule information. The mobile phone would appear to be an ideal platform for delivering this kind of content (the journalists bring their own phones, we download an application onto it, they can then use it as much or as little as they like). However there are significant issues with developing for this platform – primarily incompatibility between different handsets which would mean the code needs to be debugged several times for different phones.



An sensible alternate approach would be to have a dedicated device (pda or similar) onto which we could load an application with all the information we need. The device could be given to journalists to use for free and then perhaps rented to normal visitors. This would mean that we could feel confident in the device / application functioning as we expect, although it does mean we have to invest in some hardware / infrastructure to handle recharging, returning the devices etc.

Artist Listing

Users can browse listings of the artists showing at the biennale.



Calendar

Listing of events at the biennale. Users can select events to receive an sms reminder one hour before it begins.

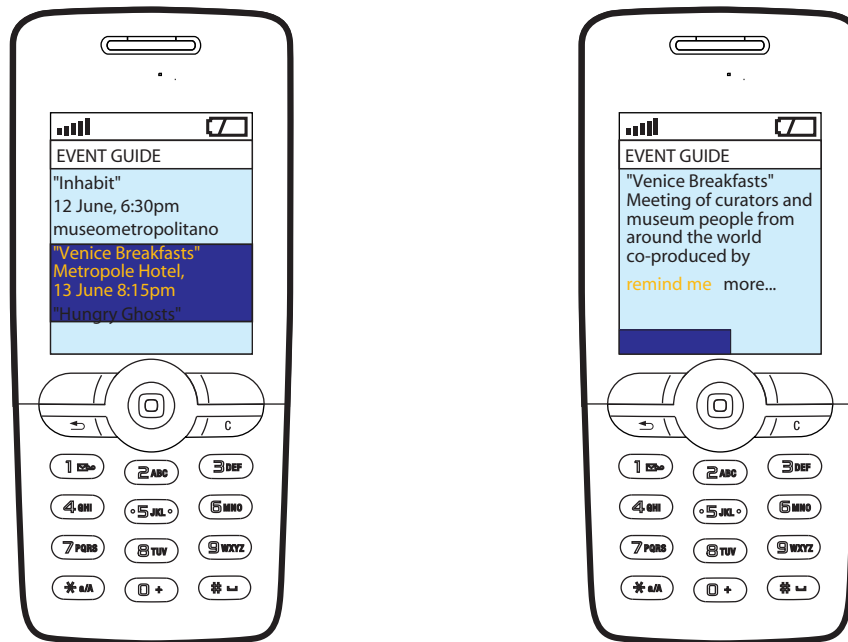

Images

Images are preloaded onto the phone. Users can send the images as an mms.

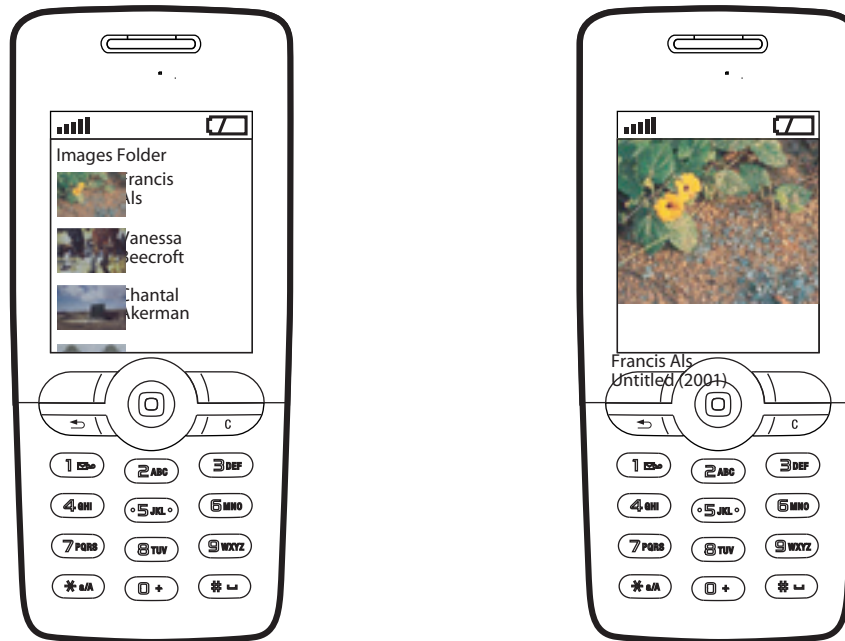

Map / Directions

Database driven map system - gives directions from any two places selected.



Audio files

Audio files are pre-loaded onto the phone. These could include a curators statement, or an artists guide.

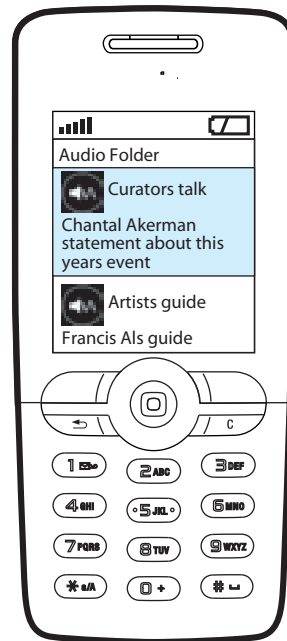

Credits

Team

e1

Interaction Design Institute Ivrea

Crispin Jones with Line Ulrika Christiansen,

Matteo Pastore and Stefano Mirti